

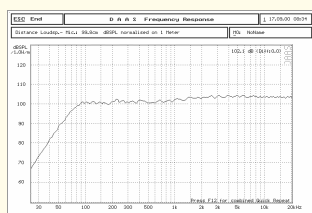

SUB-118II



Sensitivity Curve



SUB-218II

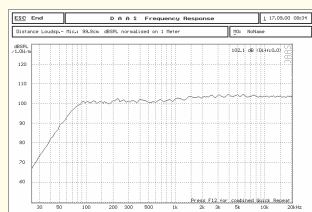

Sensitivity Curve

Specification

| | |
|---------------------------|------------------------------------|
| Frequency response | 35Hz-250KHz |
| Directivity angle | ----- |
| Long-term power(RMS) | 800W |
| Peak Power Handling | 1600W/5Min |
| Impedance | 8 ohms |
| Sensitivity | 98 dB |
| Maximum SPL | 128dB(2.83v/m) |
| Connection | 2XNL 4Speakon |
| Enclosure Construction | 15-Birch Plywood |
| Cabinet Surface Treatment | Black Catalyzed Polyurethane Paint |
| Dimensions(HxWxD) | 688x610x680mm |
| Low | 18 INx1(460mm) |
| N.W. | 56Kg |

Install Size

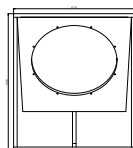

Front

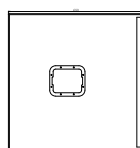

Side

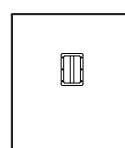

Rear

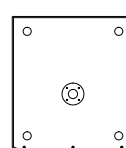

Top

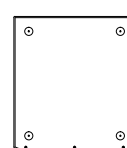

Underside

Specification

| | |
|---------------------------|------------------------------------|
| Frequency response | 30Hz-250KHz |
| Directivity angle | ----- |
| Long-term power(RMS) | 1600W |
| Peak Power Handling | 3200W/5Min |
| Impedance | 4ohms |
| Sensitivity | 102dB |
| Maximum SPL | 130dB(2.83v/m) |
| Connection | 2XNL 4Speakon |
| Enclosure Construction | 15-Birch Plywood |
| Cabinet Surface Treatment | Black Catalyzed Polyurethane Paint |
| Dimensions(HxWxD) | 610x1358x1358mm |
| Low | 2x18IN(460mm) |
| N.W. | 65Kg |

Install Size

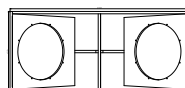

Front

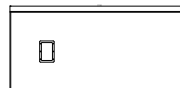

Side

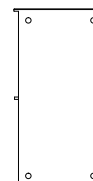

Rear



Top



Underside

www.seeraudio.com

China add: No. 106, Jin Yang YI Road, Jinhu Industrial Park Hualong Town, Pan Yu, Guangzhou, China

Tel: 0086 20 22884488 Fax: 0086 20 39945733

E-mail: seeraudio@vip.163.com / seeraudio@126.com